

OPTION A

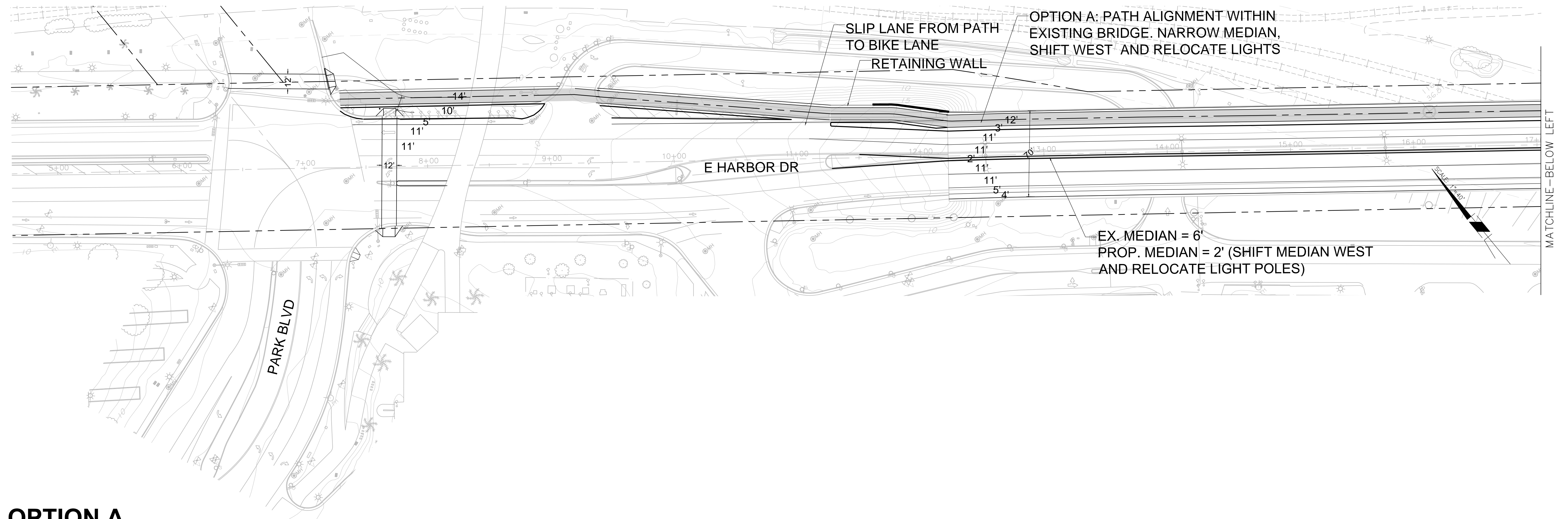

OPTION A

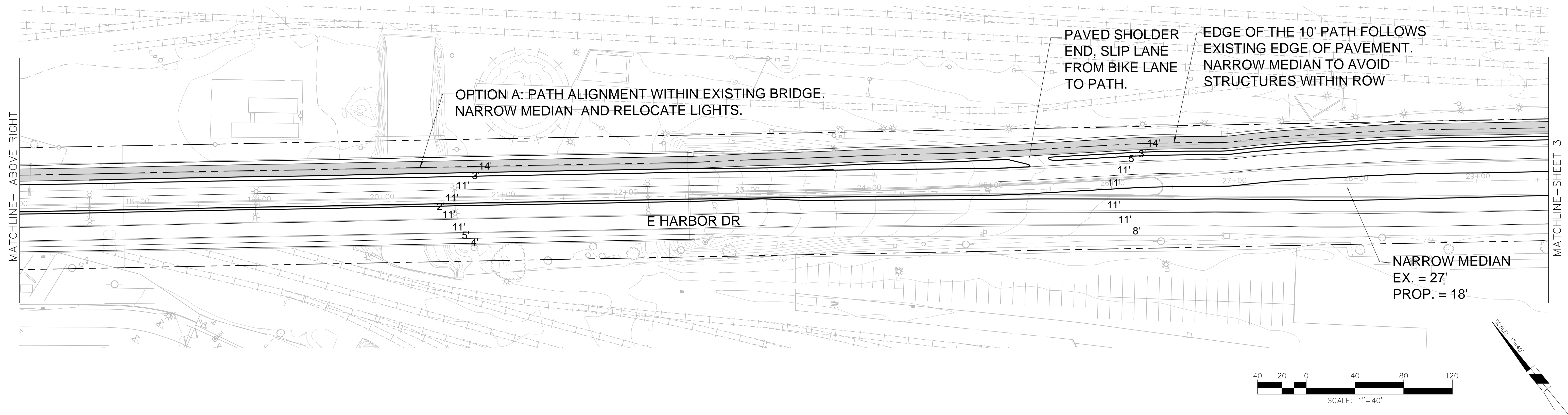

DESIGNED: CW/ED	REVISIONS
REVIEWED: CW	NO DATE ITEM
DRAWN: ED	
14-168 PROJECT NO. 01.05.2015 DATE	
AS SHOWN SCALE FILE	

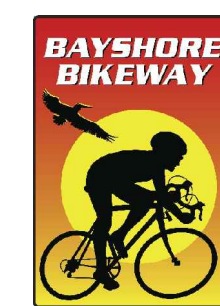

OPTION B

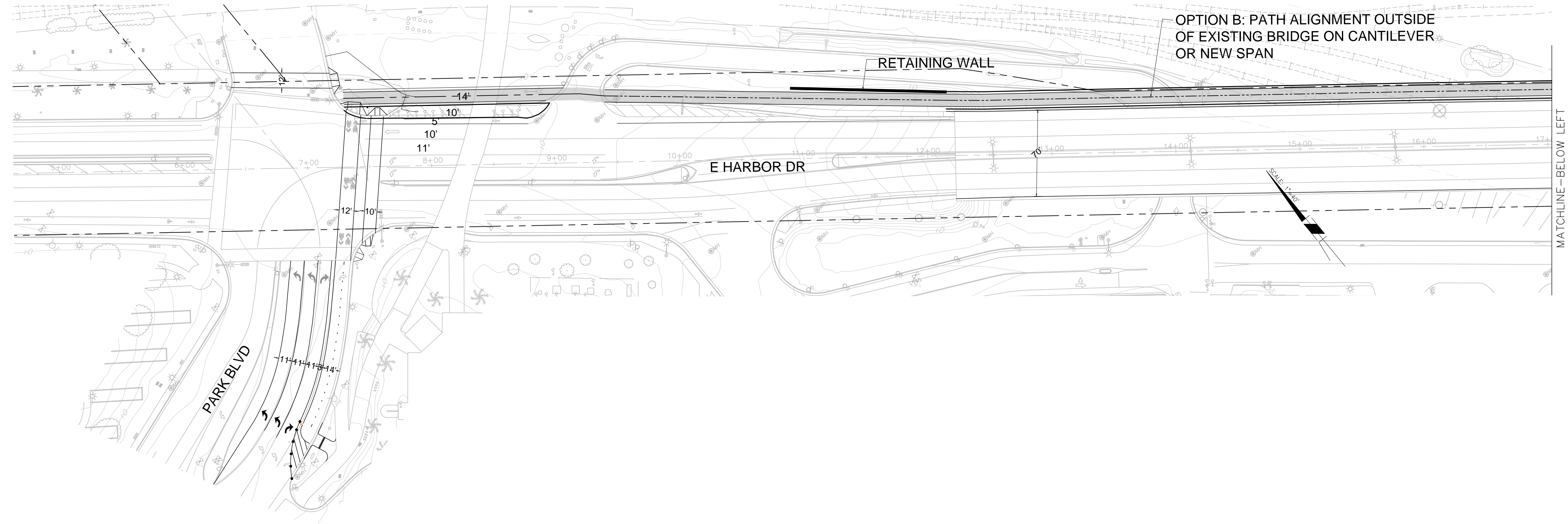

OPTION B

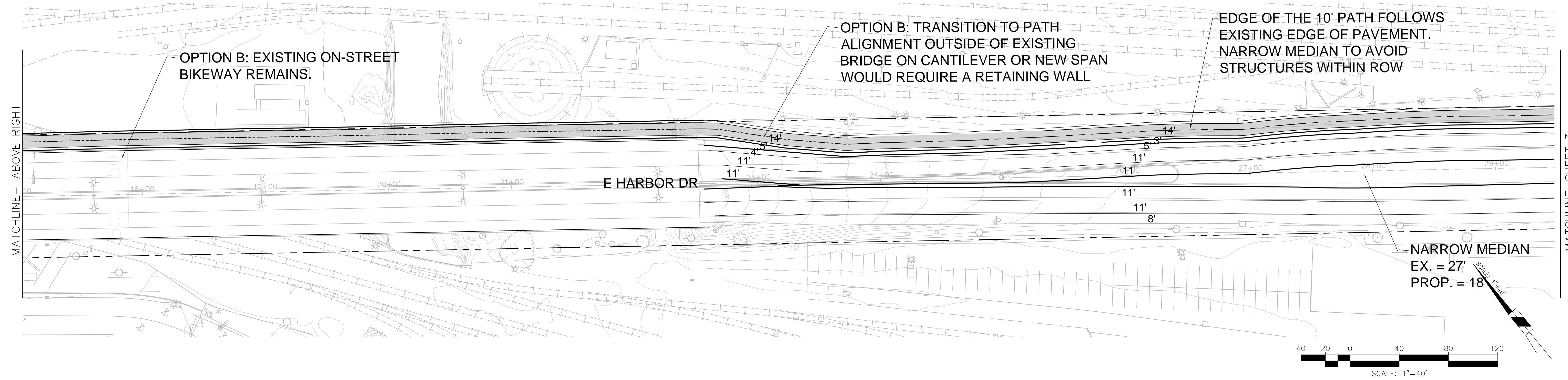

DESIGNED:	CW/ED	REVISIONS
REVIEWED:	CW	NO DATE ITEM
DRAWN:	ED	
14-168	01.05.2015	
PROJECT NO.	DATE	
AS SHOWN	FILE	
SCALE		

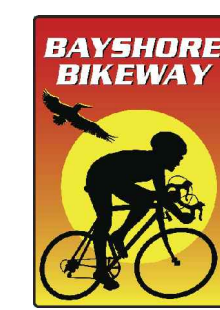

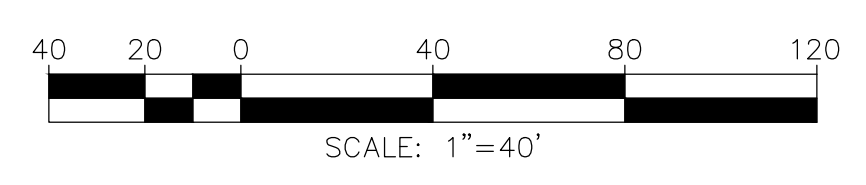
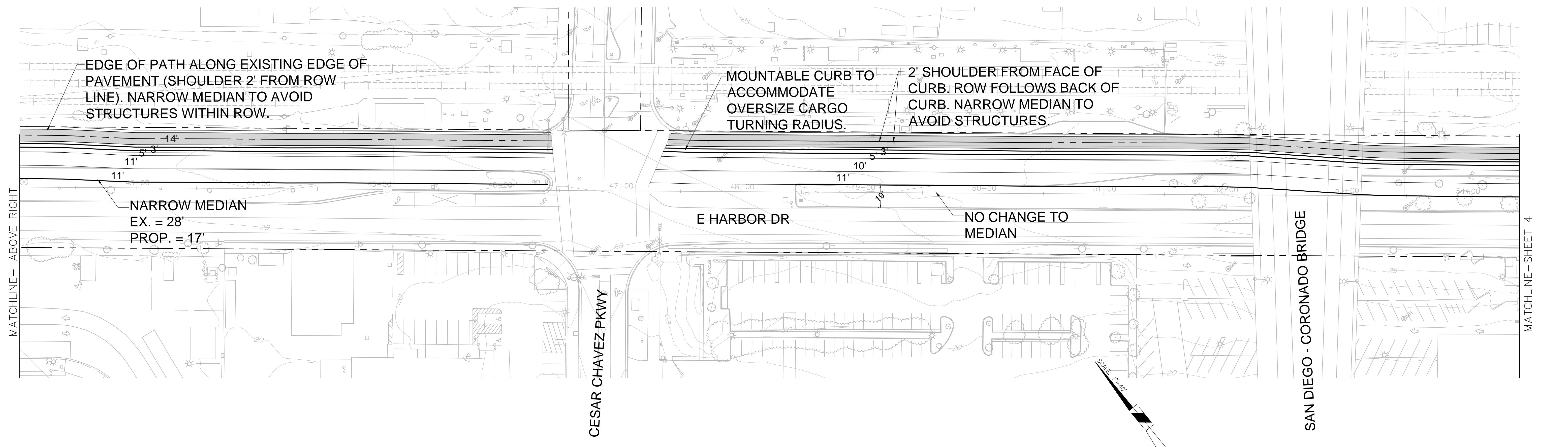
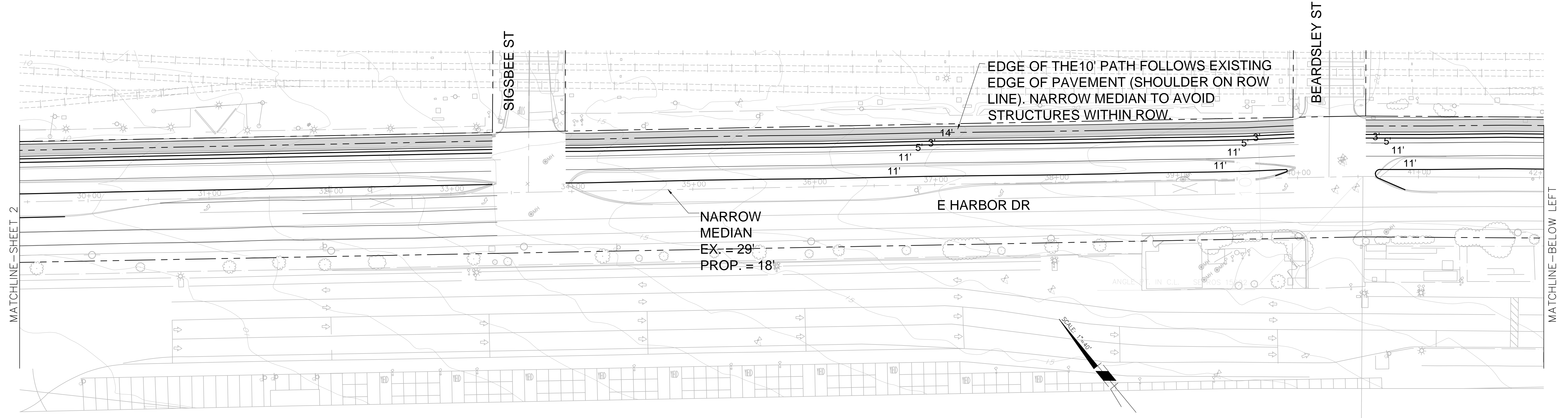

DESIGNED:	CW/ED	REVISIONS
REVIEWED:	CW	NO DATE ITEM
DRAWN:	ED	
14-168	01.05.2015	
PROJECT NO.	DATE	
AS SHOWN		
SCALE	FILE	

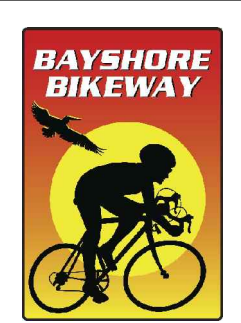

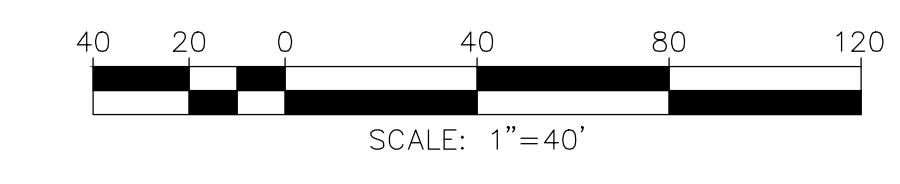
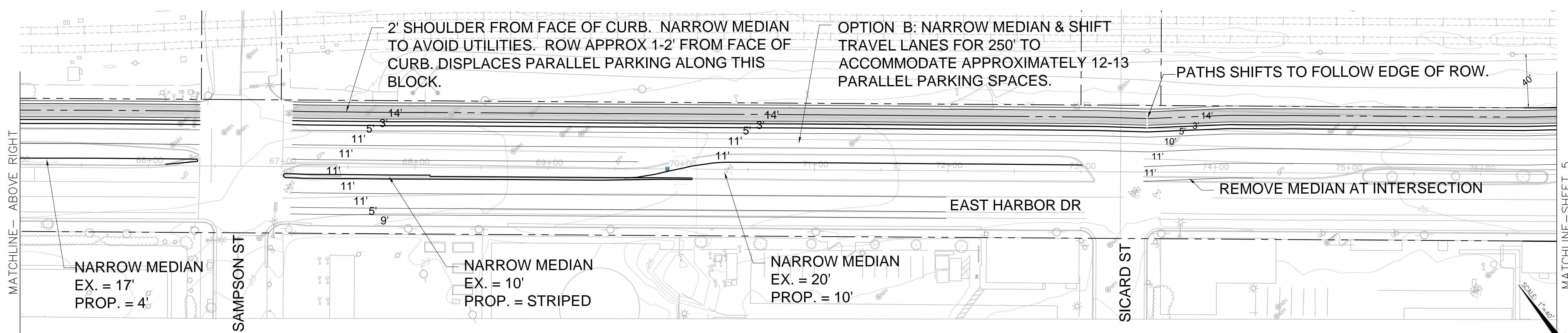
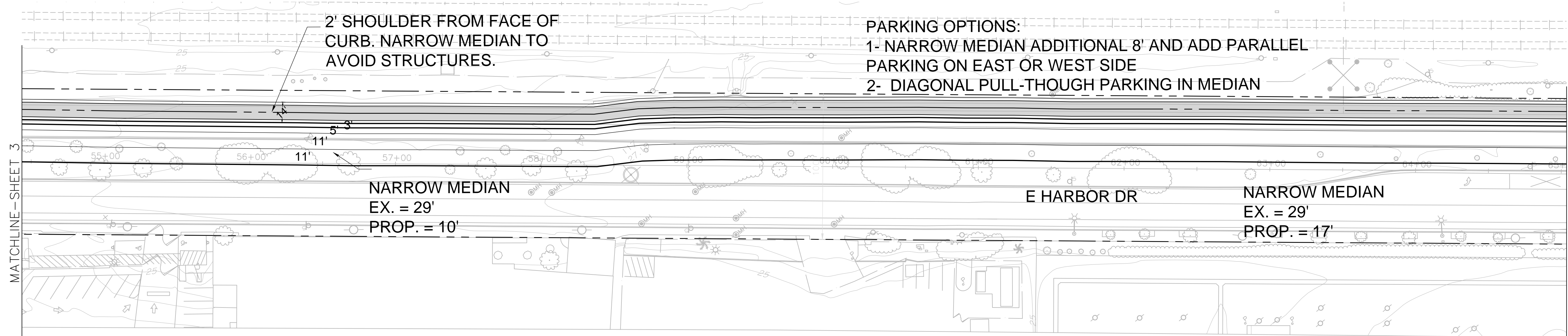

DESIGNED:	CW/ED	REVISIONS
REVIEWED:	CW	NO DATE ITEM
DRAWN:	ED	
14-168	01.05.2015	
PROJECT NO.	DATE	
AS SHOWN	FILE	
SCALE		

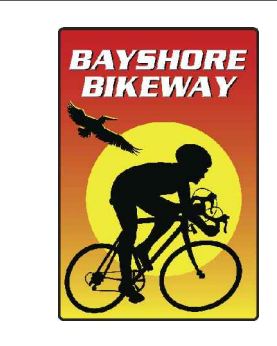

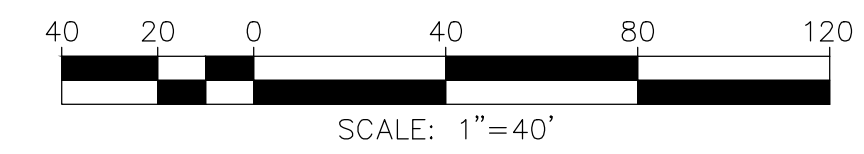
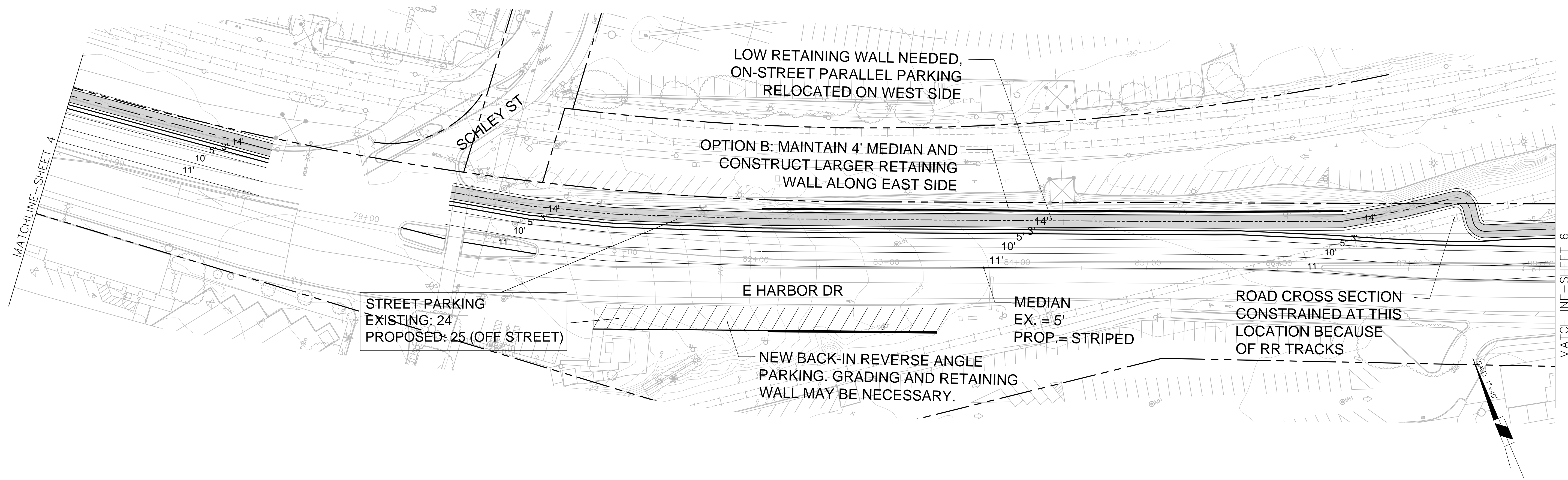

DESIGNED:	CW/ED	REVISIONS
REVIEWED:	CW	NO DATE ITEM
DRAWN:	ED	
14-168	01.05.2015	
PROJECT NO.	DATE	
AS SHOWN		
SCALE	FILE	

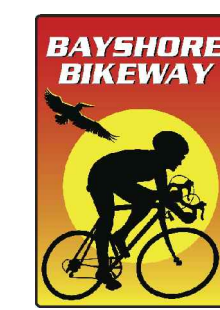

OPTION A

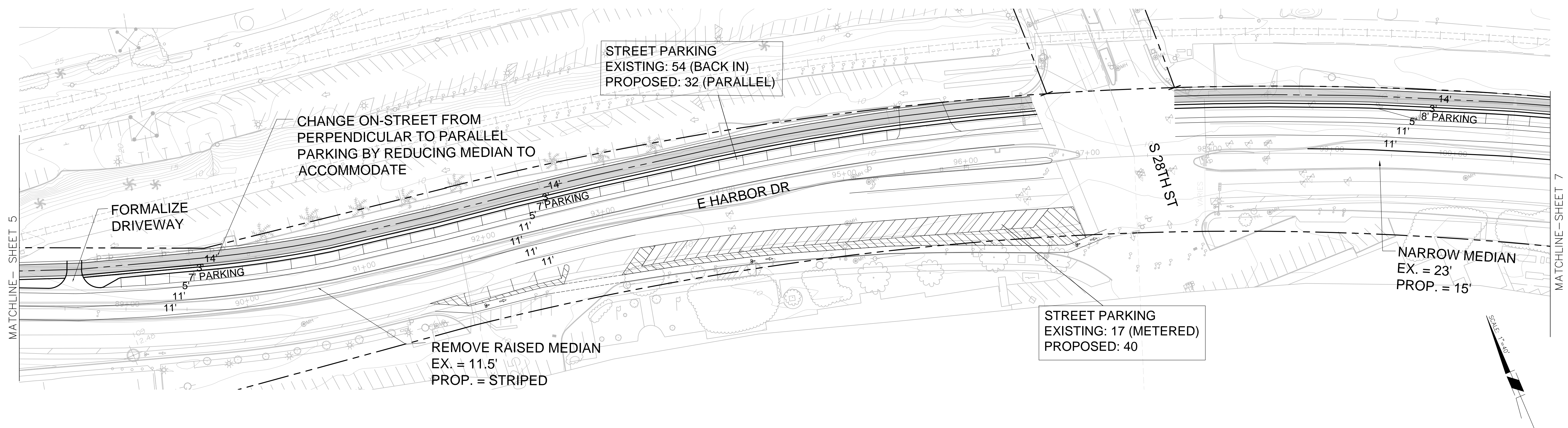

OPTION B

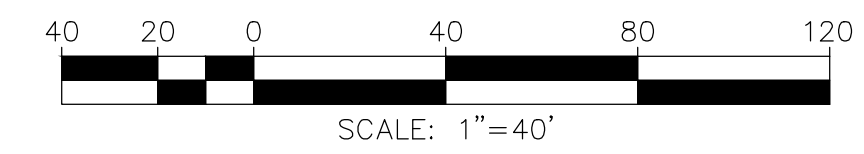
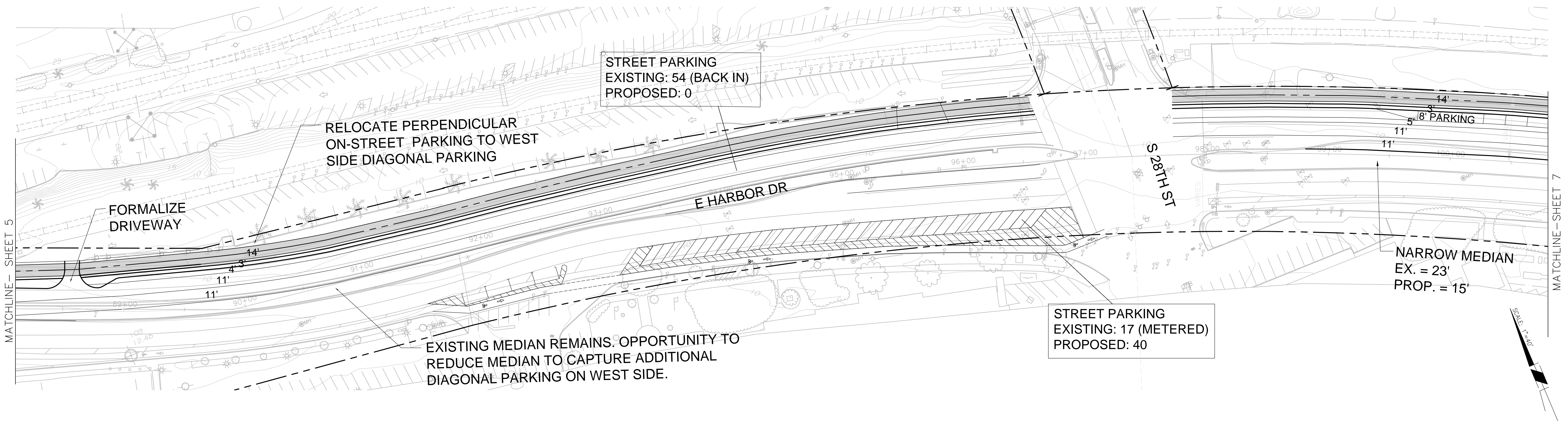

DESIGNED:	CW/ED	REVISIONS
REVIEWED:	CW	NO DATE ITEM
DRAWN:	ED	
14-168	01.05.2015	
PROJECT NO.	DATE	
AS SHOWN		
SCALE	FILE	

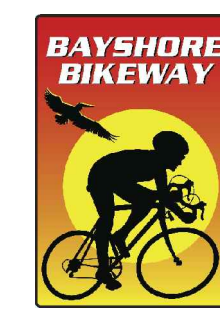

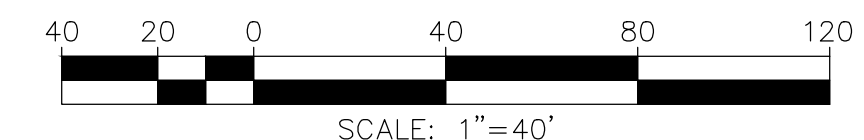
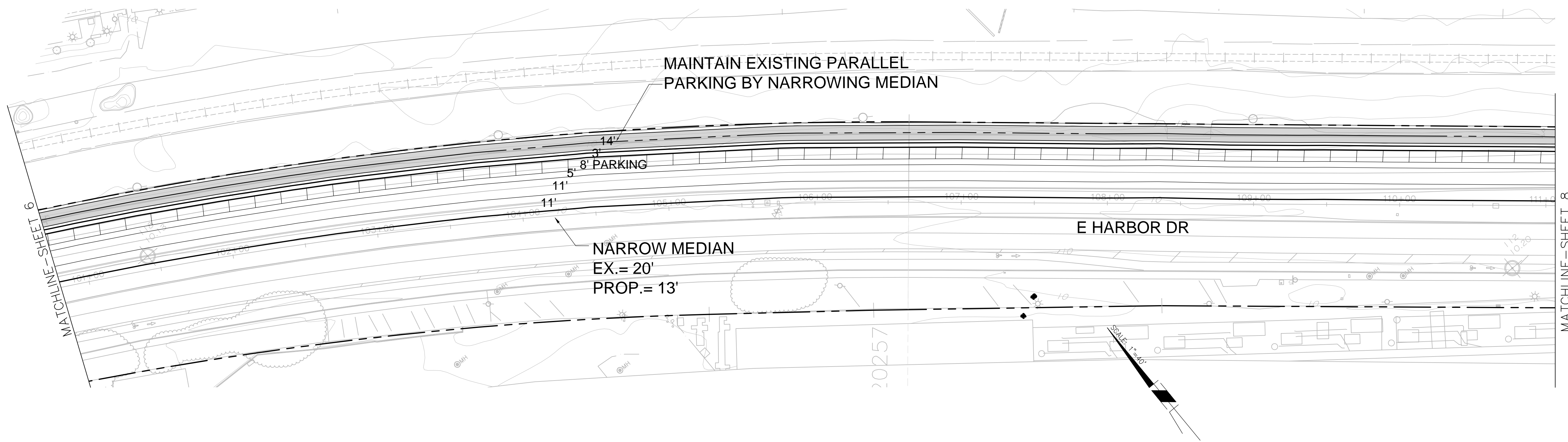

DESIGNED:	CW/ED	REVISIONS	
REVIEWED:	CW	NO	DATE
DRAWN:	ED	ITEM	
14-168	01.05.2015		
PROJECT NO.	DATE		
AS SHOWN	FILE		
SCALE			

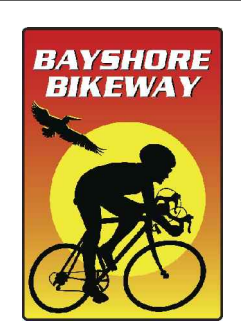

OPTION A

NOTE: PARKING LOT 6T IS LIGHTLY USED. PROPOSED PATHWAY WILL PROVIDE BETTER ACCESSIBILITY

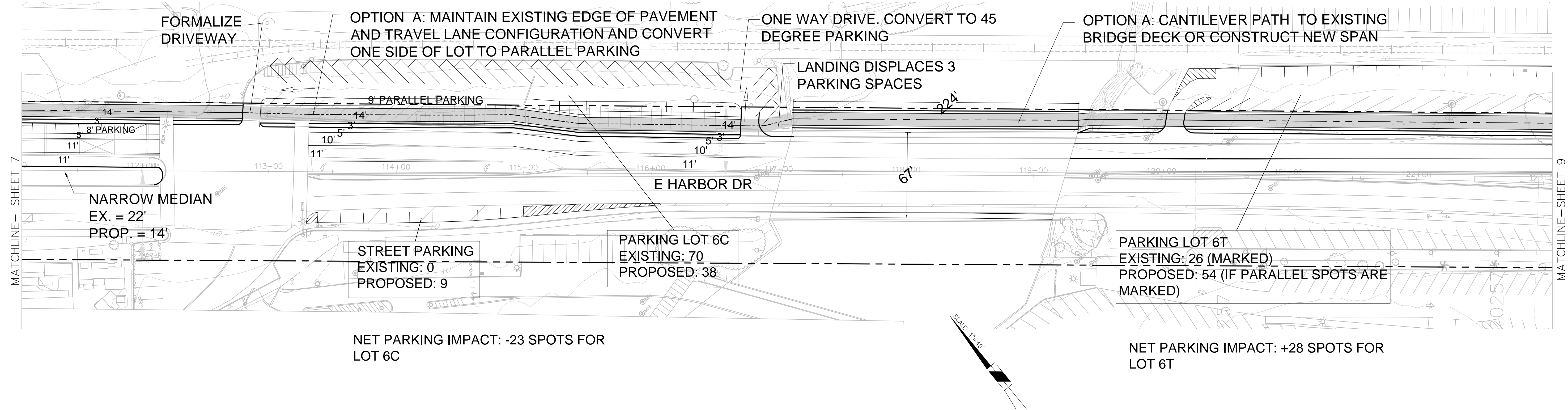

OPTION B

NOTE: PARKING LOT 6T IS LIGHTLY USED. PROPOSED PATHWAY WILL PROVIDE BETTER ACCESSIBILITY

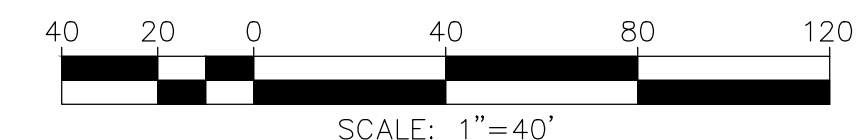
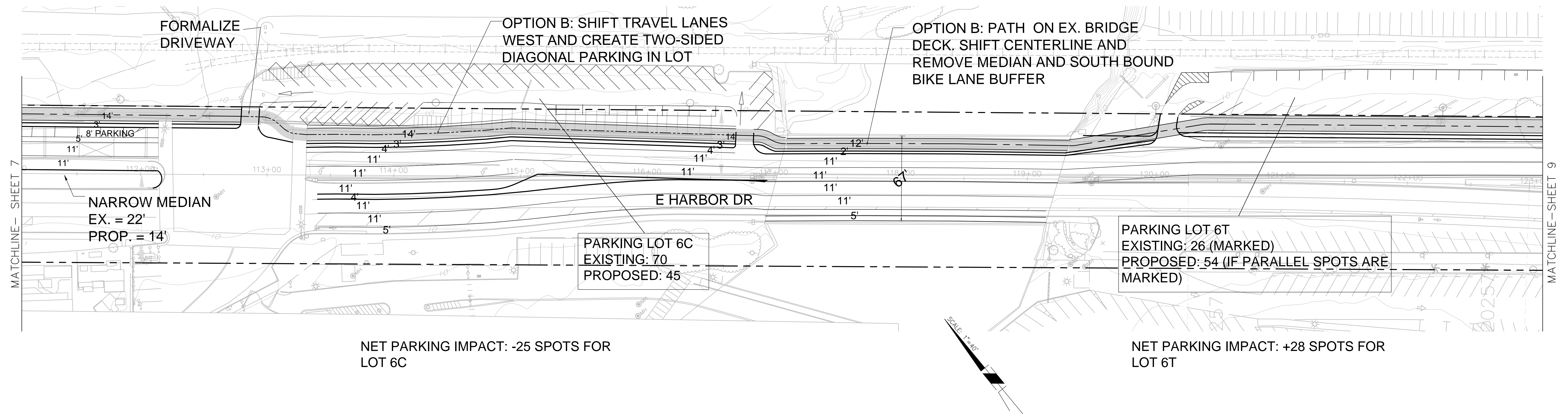

DESIGNED:	CW/ED	REVISIONS
REVIEWED:	CW	NO DATE ITEM
DRAWN:	ED	
14-168	01.05.2015	
PROJECT NO.	DATE	
AS SHOWN	FILE	
SCALE		

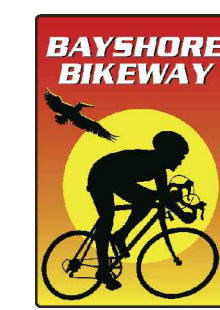

OPTION A - 32ND STREET CROSSING

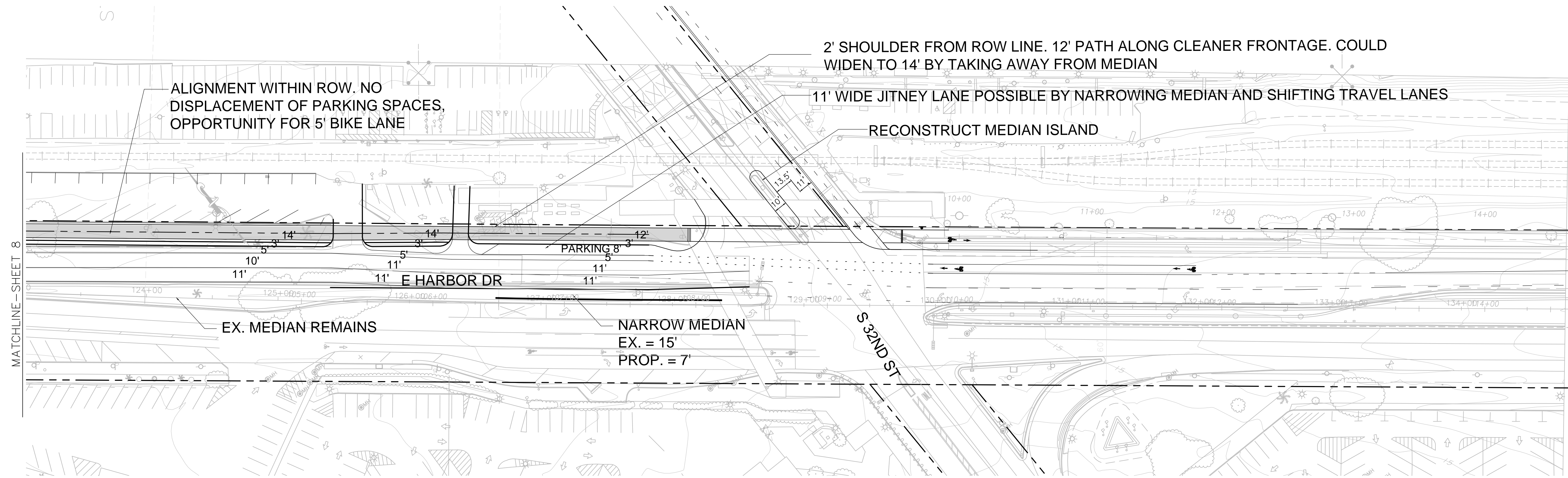

OPTION B - 32ND STREET CROSSING

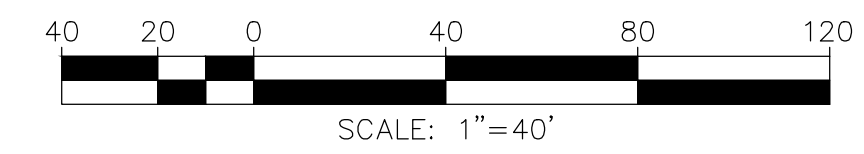
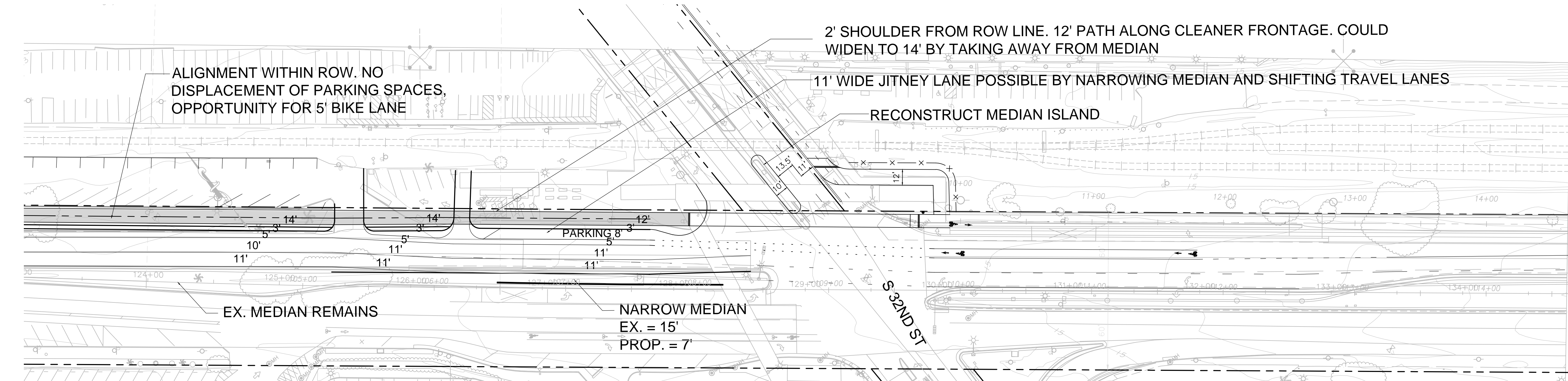

DESIGNED:	CW/ED	REVISIONS
REVIEWED:	CW	NO DATE ITEM
DRAWN:	ED	
14-168	01.05.2015	
PROJECT NO.	DATE	
AS SHOWN	FILE	
SCALE		

