

The list below shows planned closures and detours as part of highway, rail, bike, pedestrian, and lagoon improvement projects. Detour signs will be placed, as needed, to assist motorists through closures. Please note, these closures are subject to change.

Week of March 7

HIGHWAY

- Residents and motorists should expect intermittent nighttime construction noise, lane closures, and ramp closures along **I-5** between **Lomas Santa Fe Drive** in Solana Beach and **Palomar Airport Road** in Carlsbad from Sunday, March 7, through Thursday, March 11, from 9 p.m. – 5 a.m. for roadway excavation, earthwork hauling and placement, landscape and irrigation, drainage installation, and maintenance.
- Residents and motorists should expect intermittent nighttime construction noise, lane closures, and ramp closures along **Manchester Avenue** at **I-5** from Sunday, March 7, through Thursday, March 11, from 9 p.m. – 5 a.m. for bridge foundation and bridge column work, roadway restriping, and k-rail placement.

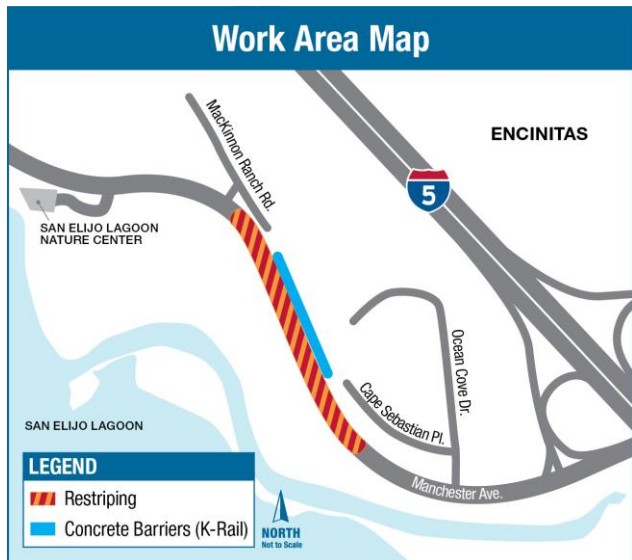

- Residents and motorists should expect intermittent daytime construction noise, flagging operations, and reduced lane widths along **Manchester Avenue** at **I-5** from Monday, March 8, through Friday, March 12, from 7 a.m. – 5 p.m. for bridge foundation and bridge column work, and utility installation.
- Residents and businesses should expect intermittent daytime construction noise along **I-5** between **Lomas Santa Fe Drive** in Solana Beach and **Palomar Airport Road** in Carlsbad from Monday, March 8, through Friday, March 12 from 7 a.m. – 5 p.m. for roadway excavation, roadway paving, earthwork hauling and placement, drainage and electrical infrastructure installation, and embankment construction.

LAGOON/BIKE/PEDESTRIAN

- Residents and businesses along **N. Rios Avenue** in Solana Beach and **Manchester Avenue** in Encinitas can expect an increase in vehicle and equipment traffic as well as general vehicle noise and back-up



alarms from Monday, March 8, through Friday, March 12, from 7 a.m. – 5 p.m. for transport and hauling of dirt, equipment, plants, and other materials to and from the San Elijo Lagoon.

- To view current San Elijo Lagoon trail closures please visit thenaturecollective.org/trails. For information on the San Elijo Lagoon Restoration project, please visit thenaturecollective.org/project/san-elijo-lagoon-restoration.

Sign up for project updates at KeepSanDiegoMoving.com/BuildNCC,
or text **BuildNCC** to **313131** to receive construction alerts. For questions, please call **844-NCC-0050**.