

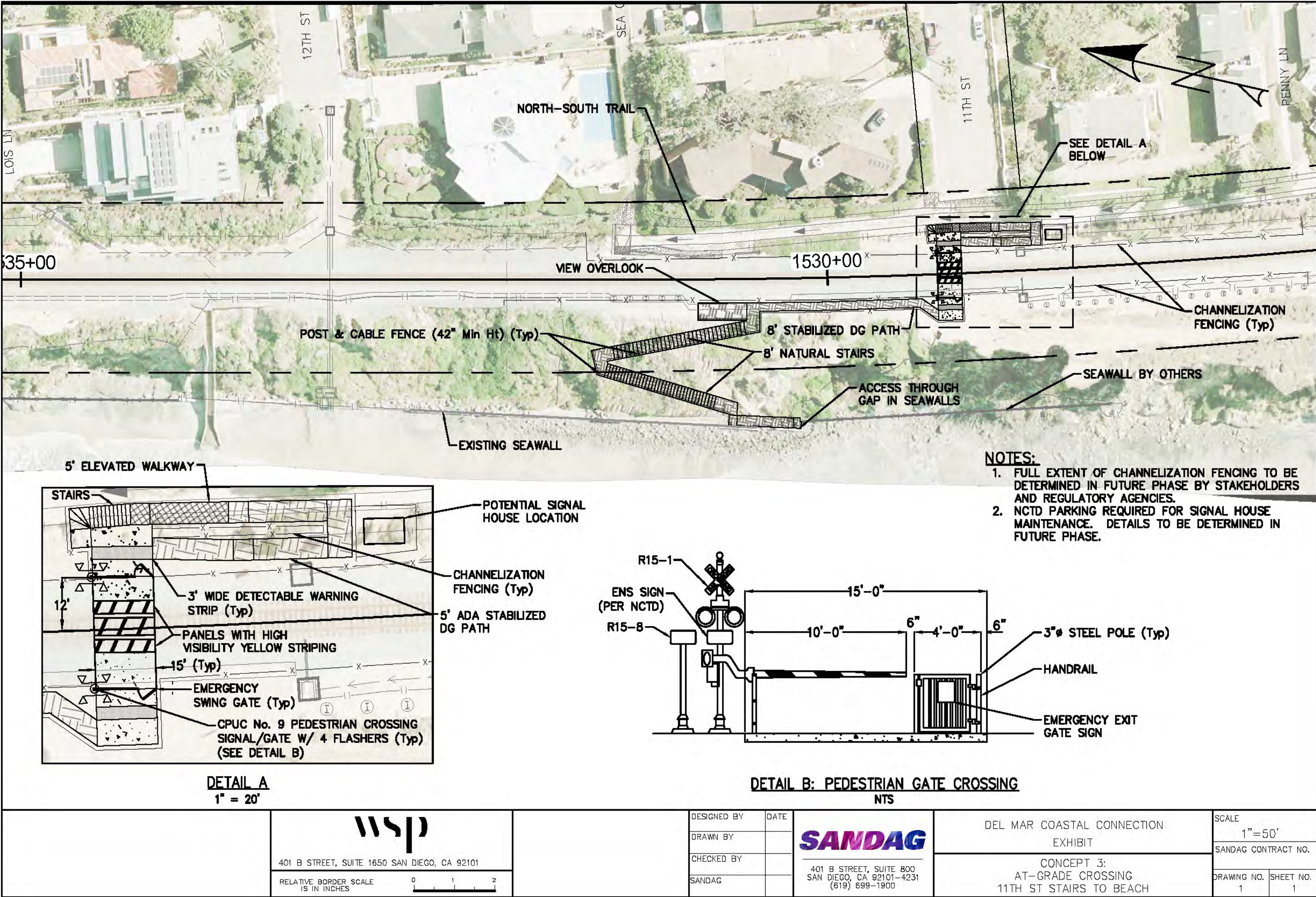

Concept 3: At-Grade Crossing at 11th Street

Stairs to Beach

This at-grade railroad crossing takes advantage of existing east-west movement patterns and a large area of artificial fill on the western bluffs north of 11th Street.

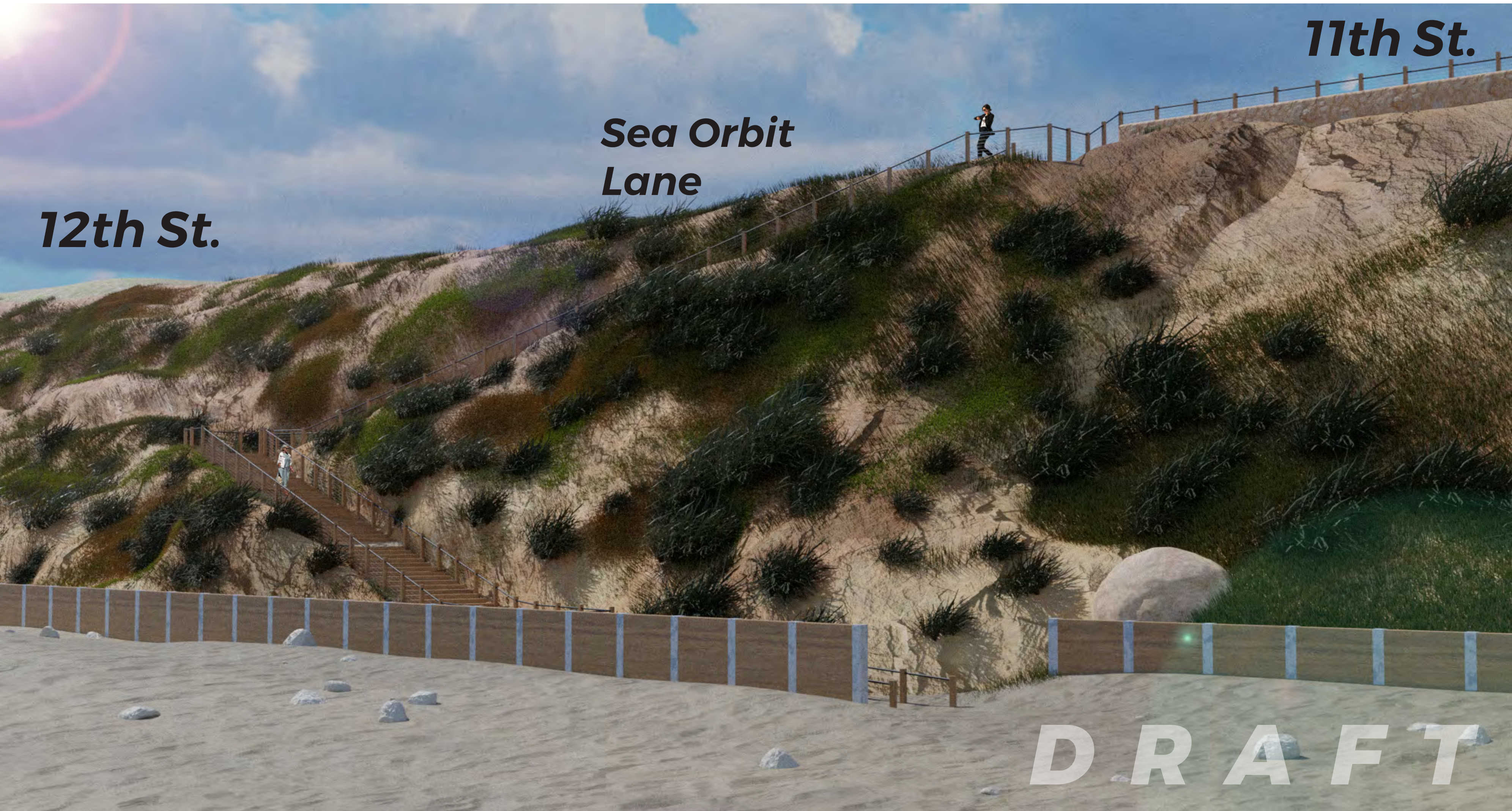

Notable features include:

- **Natural Stairs:** Designed to match the existing informal paths along the bluffs, natural stairs are graded into the terrain using timber or stone. Steeper portions may require retaining walls, some of which may be below grade and/or covered with fill and landscaping to reduce visual impacts.
- **Accessible Paths:** All paths except the natural stairs feature ADA-compliant grades and can utilize a special form of stabilized decomposed granite for an accessible surface.
- **View Overlook:** On the western bluff top, a view overlook is a new amenity that would be accessible from 11th Street and optionally Concept 1, North-South Trail.
- **At-Grade Railroad Crossing:** Located near the end of 11th Street and includes:
 - o Gates, Lights & Bells: Standard safety features per CPUC requirements.
 - o Safety Fencing: Full extent to be determined in collaboration with CPUC, CCC, NCTD, and City of Del Mar.
 - o Signal House: Requires NCTD access and parking from the end of 11th Street.
- **Connection to 11th Street:** Accessible path from 11th Street connects to the existing network. This also features an optional connection to Concept 1, North-South Trail.

