



BORDER TO BAYSHORE BIKEWAY

San Ysidro Community Planning Group
August 20, 2018



HOW DOES THE BORDER TO BAYSHORE BIKEWAY FIT IN?

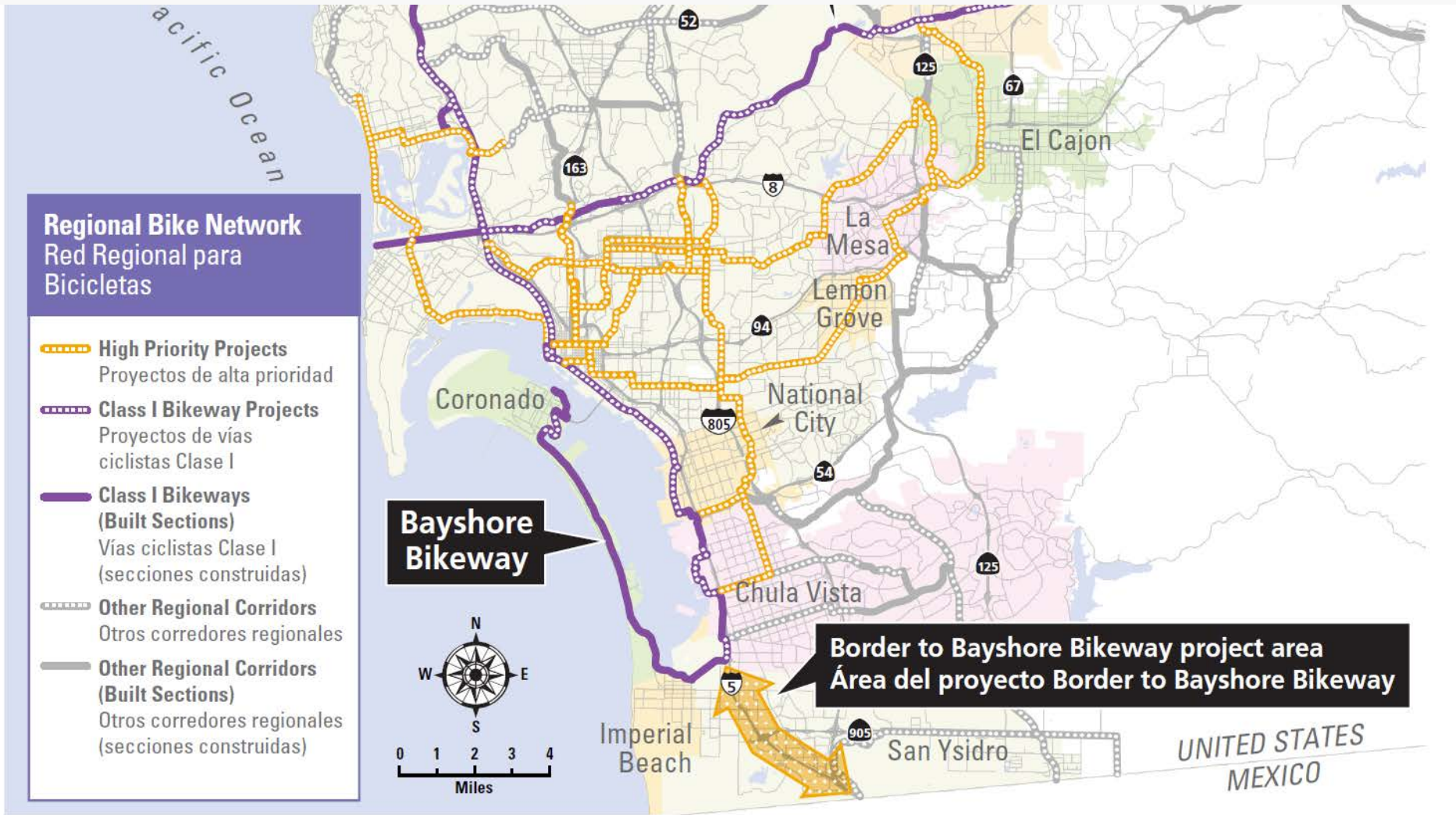

Regional Bike Network Red Regional para Bicicletas

- High Priority Projects**
Proyectos de alta prioridad
- Class I Bikeway Projects**
Proyectos de vías ciclistas Clase I
- Class I Bikeways (Built Sections)**
Vías ciclistas Clase I (secciones construidas)
- Other Regional Corridors**
Otros corredores regionales
- Other Regional Corridors (Built Sections)**
Otros corredores regionales (secciones construidas)

Bayshore Bikeway

Border to Bayshore Bikeway project area
Área del proyecto Border to Bayshore Bikeway

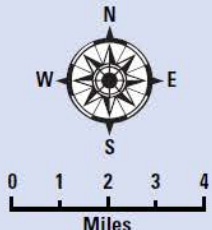

UNITED STATES
MEXICO



EVERYDAY PEOPLE, EVERYDAY TRIPS

No way

**Interested,
but concerned**

(potential bikeway users)

**Anywhere,
anytime**





SAFE “LOW STRESS” STREETS

- Safe movement of people
- Protected bikeways provide separation
- Traffic calming to reduce speeds
- Challenges in urban areas due to limited space and competing uses





1st COMMUNITY MEETING, SOUTHWEST HIGH SCHOOL





WHICH PLACES SHOULD BE CONNECTED BY THE BIKEWAY?





DEVELOPING BIKE ROUTE OPTIONS: CONSIDER ALL SUGGESTED OPTIONS

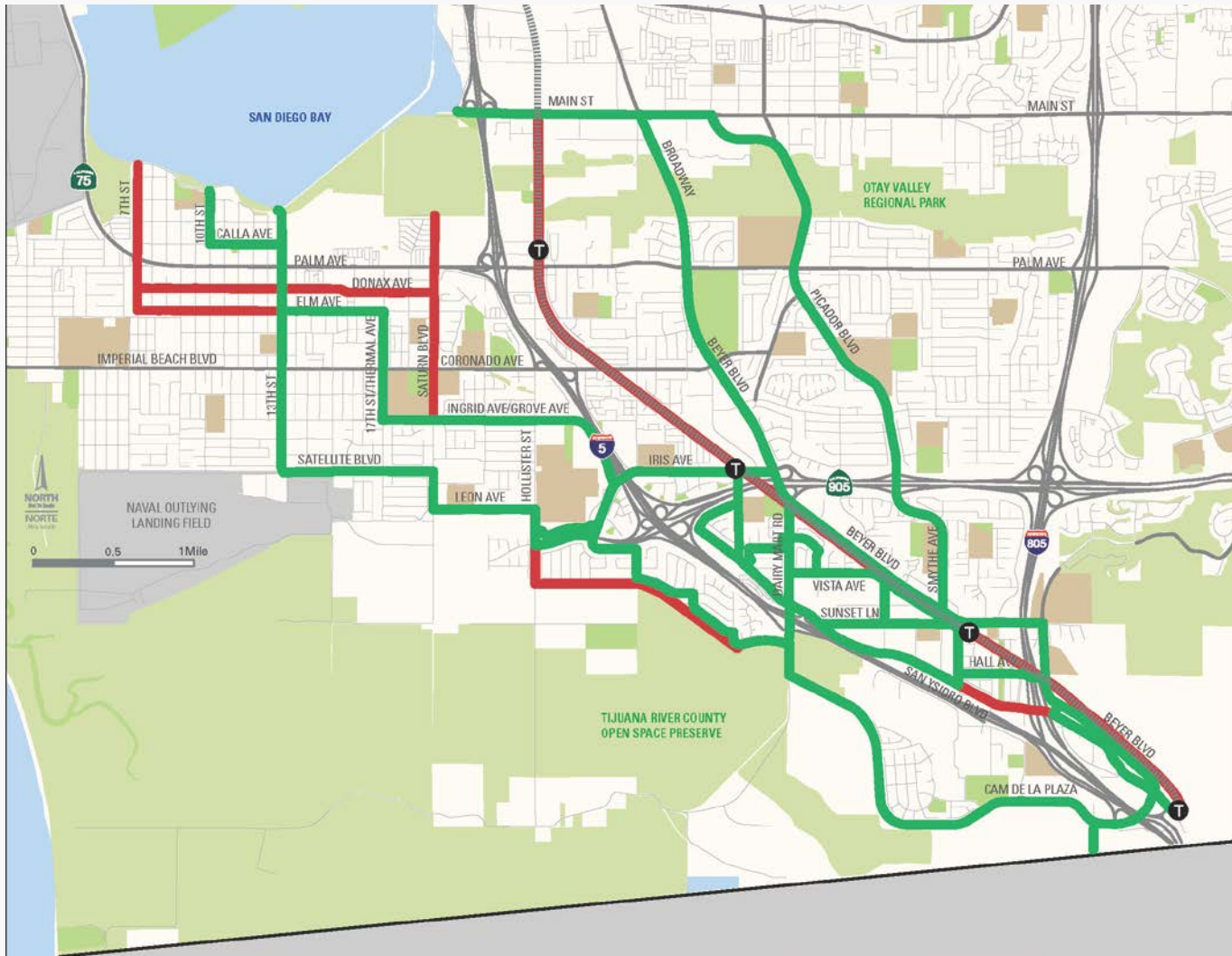



FINAL BIKE ROUTE OPTIONS





2nd COMMUNITY MEETING, IMPERIAL BEACH PUBLIC LIBRARY





PREFERRED ROUTE





BORDER TO BAYSHORE BIKEWAY SAN YSIDRO

Beyer Boulevard (Segment 1 of 6)



DRAFT



BORDER TO BAYSHORE BIKEWAY SAN YSIDRO

Beyer Boulevard (Segments 2-3 of 6)

DRAFT

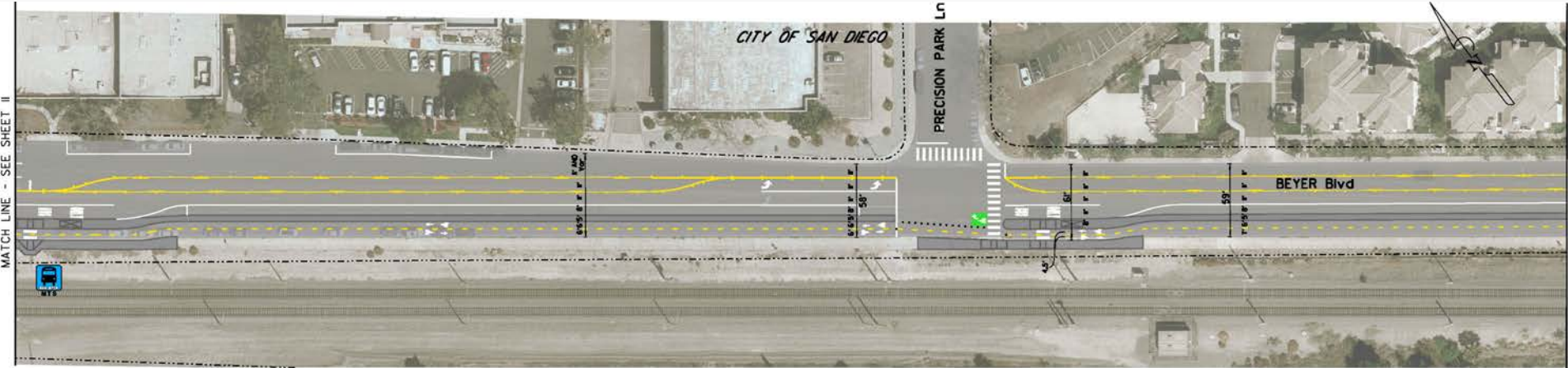



BORDER TO BAYSHORE BIKEWAY SAN YSIDRO

Beyer Boulevard (Segments 4-5 of 6)

DRAFT

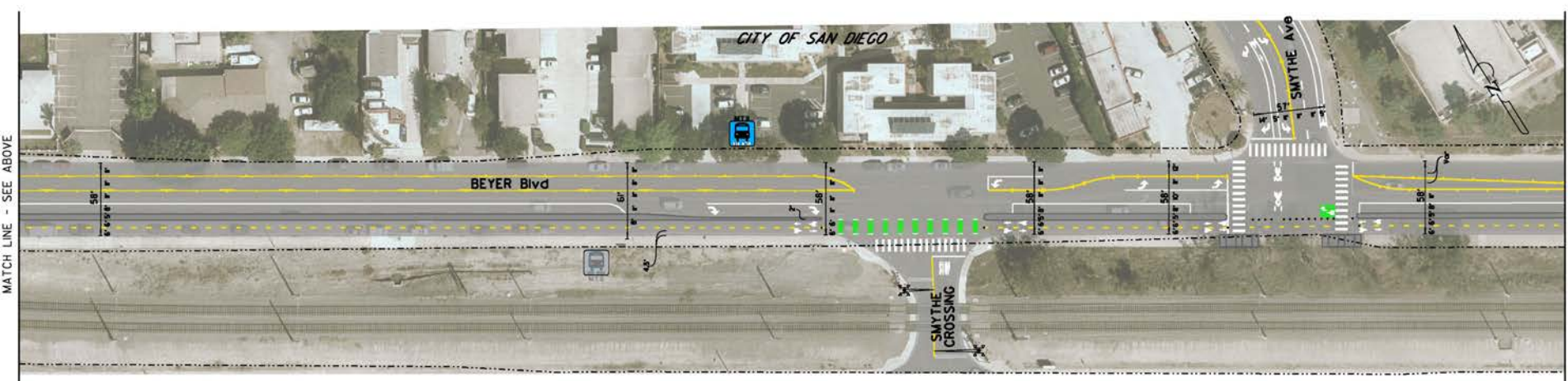



BORDER TO BAYSHORE BIKEWAY SAN YSIDRO

Beyer Boulevard (Segment 6 of 6)

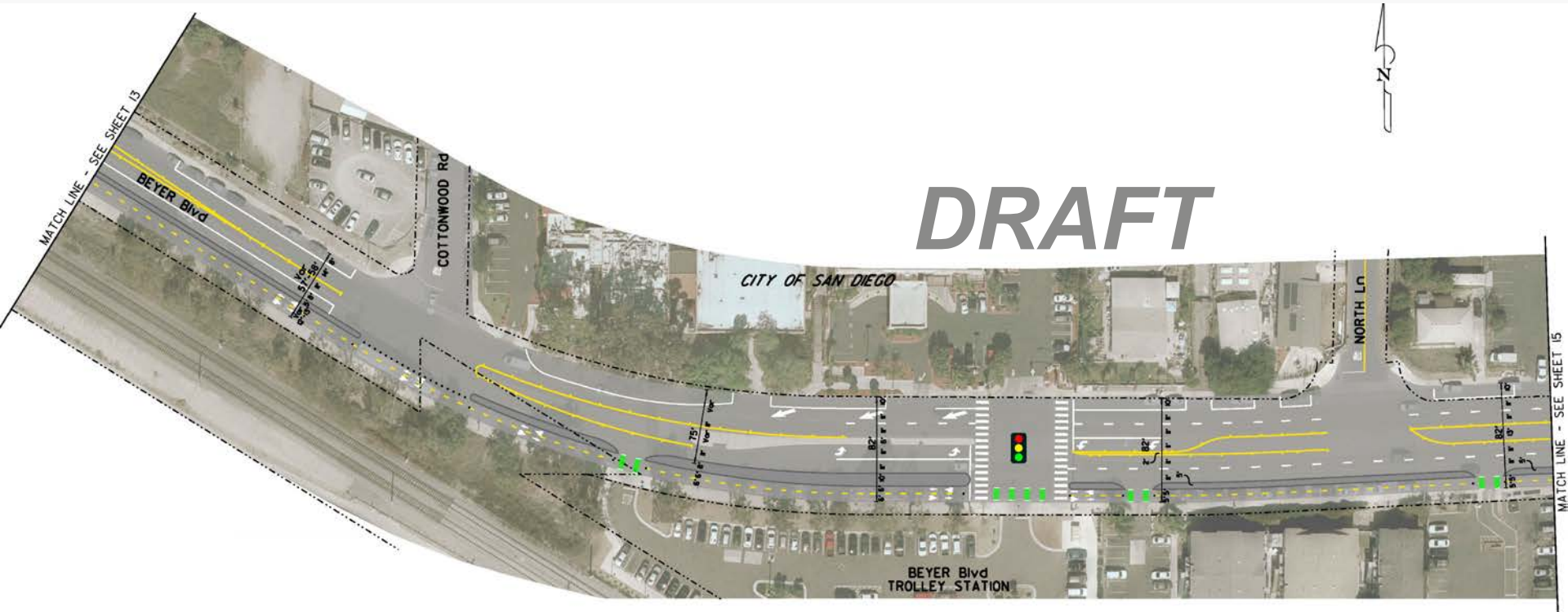



BORDER TO BAYSHORE BIKEWAY SAN YSIDRO

Park Avenue (Segment 1 of 2)

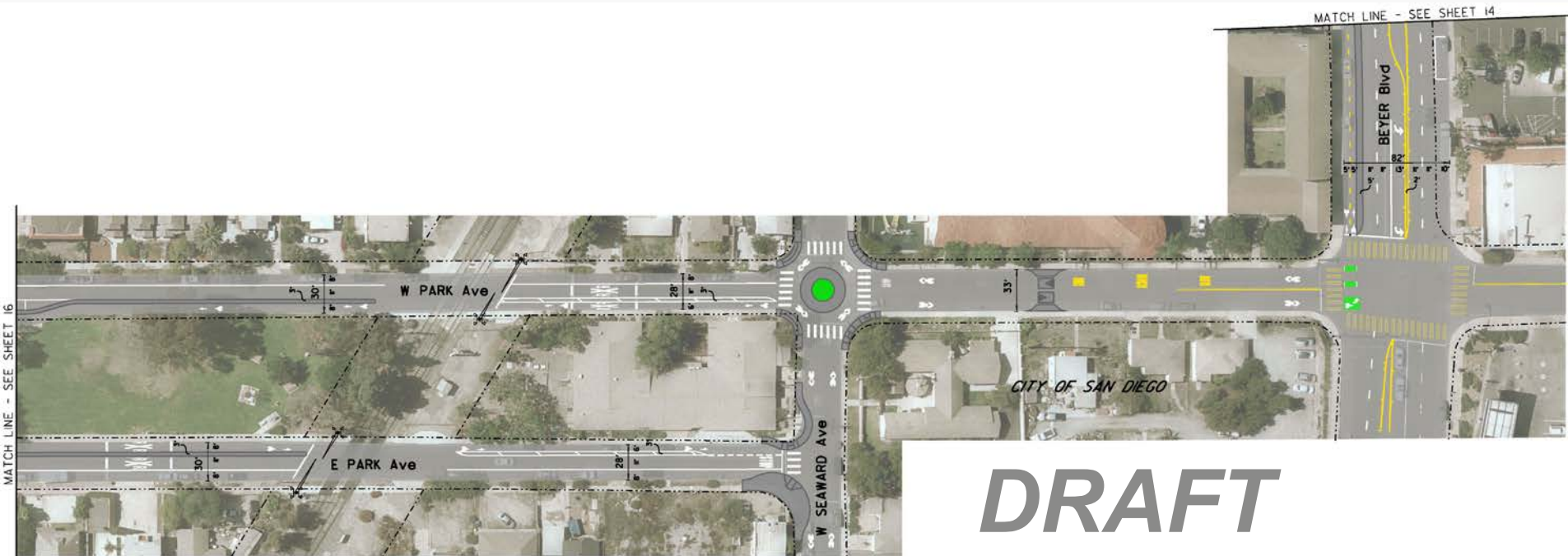

DRAFT



BORDER TO BAYSHORE BIKEWAY SAN YSIDRO

Park Avenue (Segment 2 of 2)





BORDER TO BAYSHORE BIKEWAY SAN YSIDRO

East Beyer Boulevard

DRAFT

CITY OF SAN DIEGO

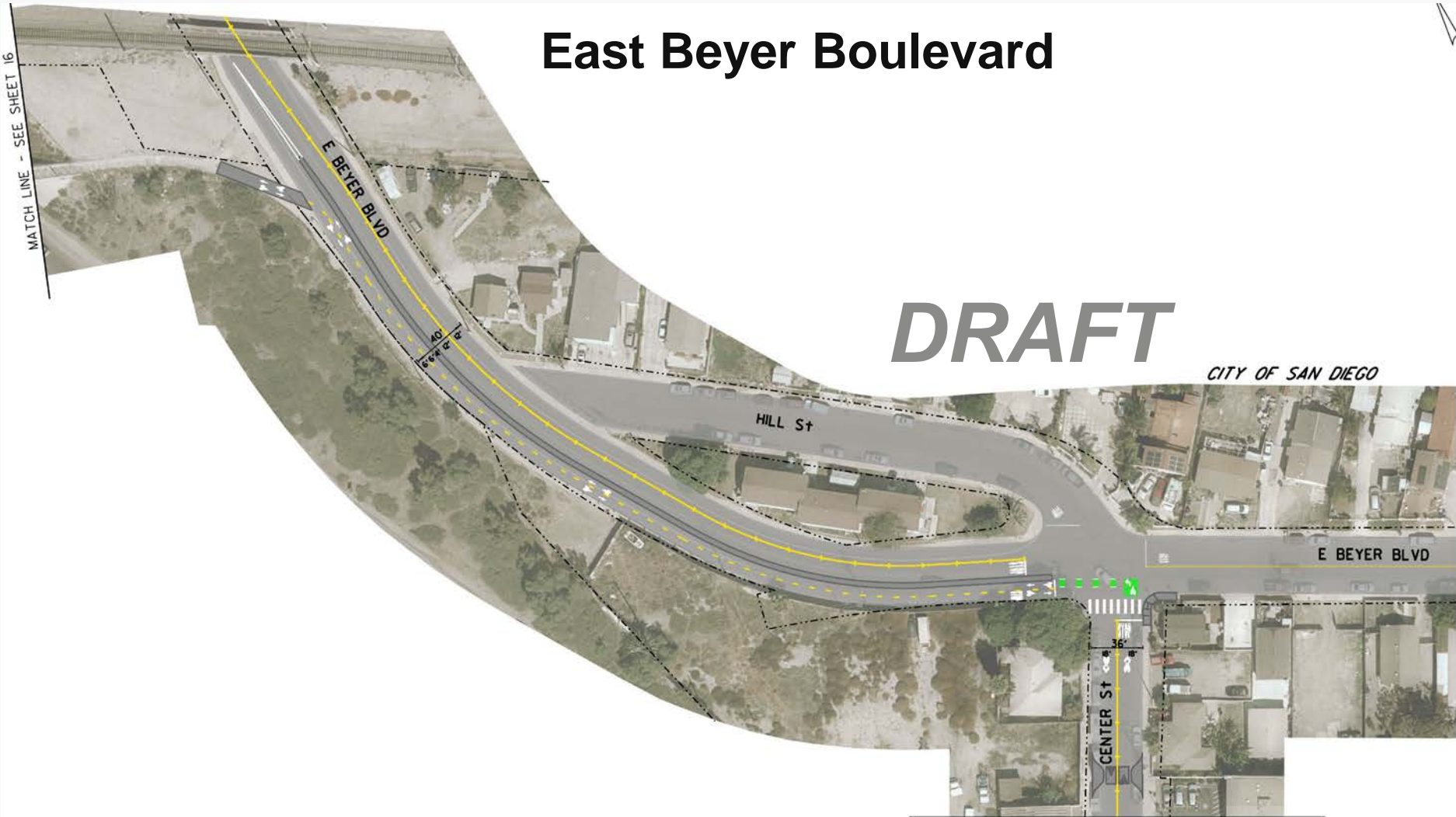



BORDER TO BAYSHORE BIKEWAY SAN YSIDRO

East San Ysidro Boulevard (Segment 1 of 4)

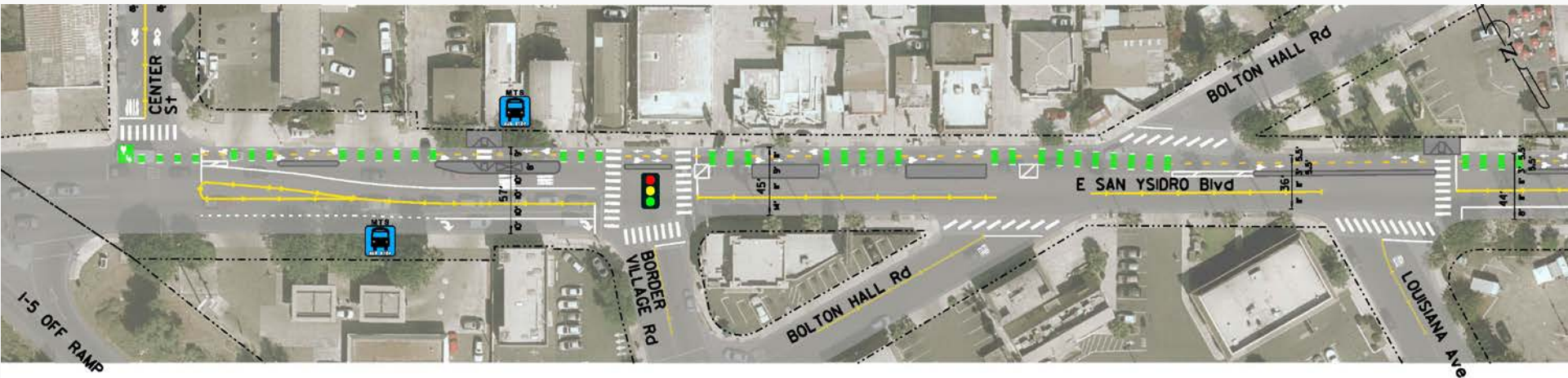

DRAFT



BORDER TO BAYSHORE BIKEWAY SAN YSIDRO

East San Ysidro Boulevard (Segment 1 of 4)

Parking: Preliminary Estimate
Removed / Preserved

4

2

1

3

1

2

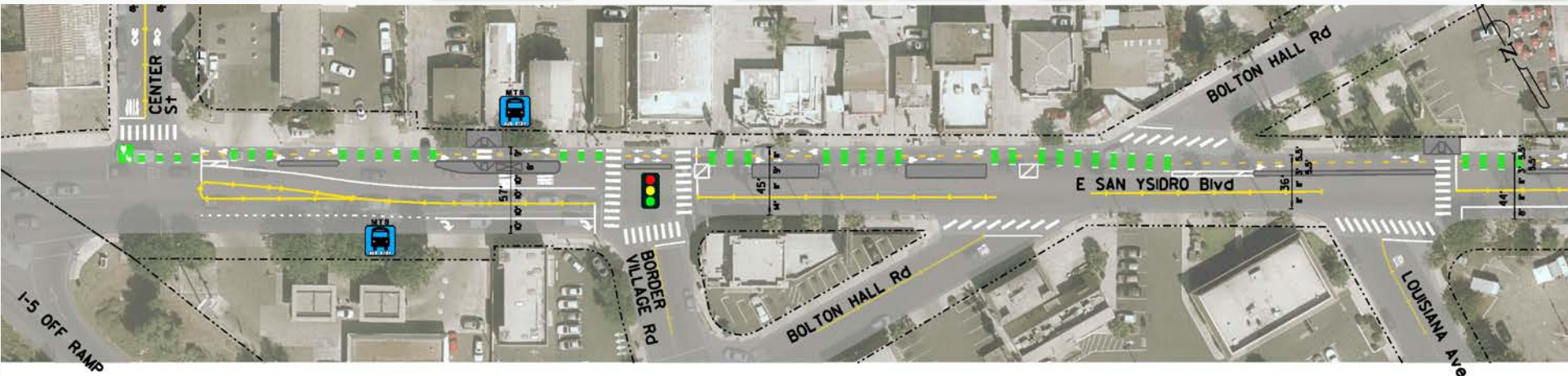

Parking: Preliminary Estimate
Removed / Preserved

DRAFT

4

Removal of Center
Turn Lane:





BORDER TO BAYSHORE BIKEWAY SAN YSIDRO

East San Ysidro Boulevard (Segment 2 of 4)

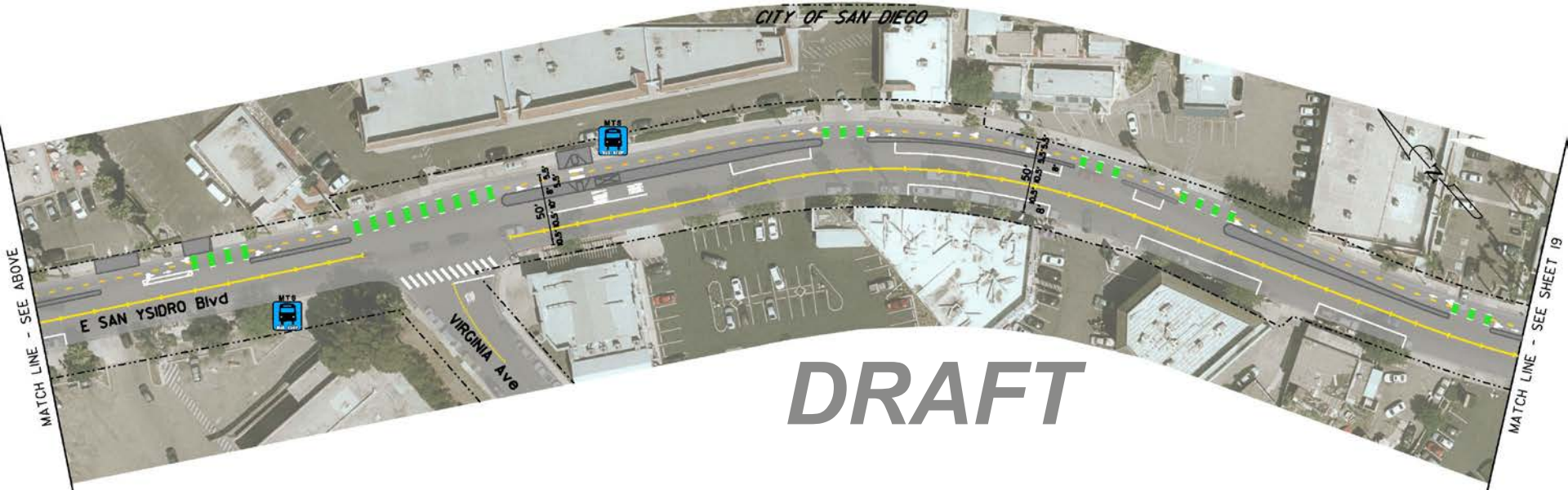

DRAFT



BORDER TO BAYSHORE BIKEWAY SAN YSIDRO

East San Ysidro Boulevard (Segment 2 of 4)

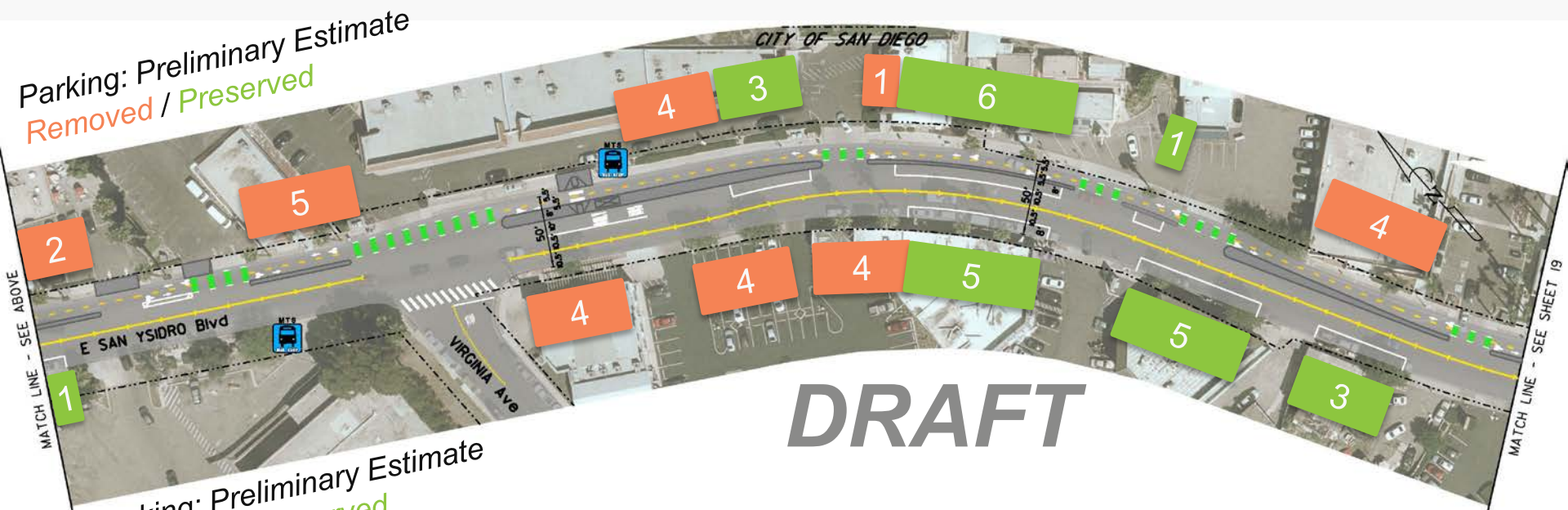

Removal of Center Turn Lane:





BORDER TO BAYSHORE BIKEWAY SAN YSIDRO

East San Ysidro Boulevard (Segment 3 of 4)



DRAFT



BORDER TO BAYSHORE BIKEWAY SAN YSIDRO

East San Ysidro Boulevard (Segment 3 of 4)



DRAFT

No Center Turn Lane impacts to this segment



BORDER TO BAYSHORE BIKEWAY SAN YSIDRO

East San Ysidro Boulevard (Segment 4 of 4)

DRAFT

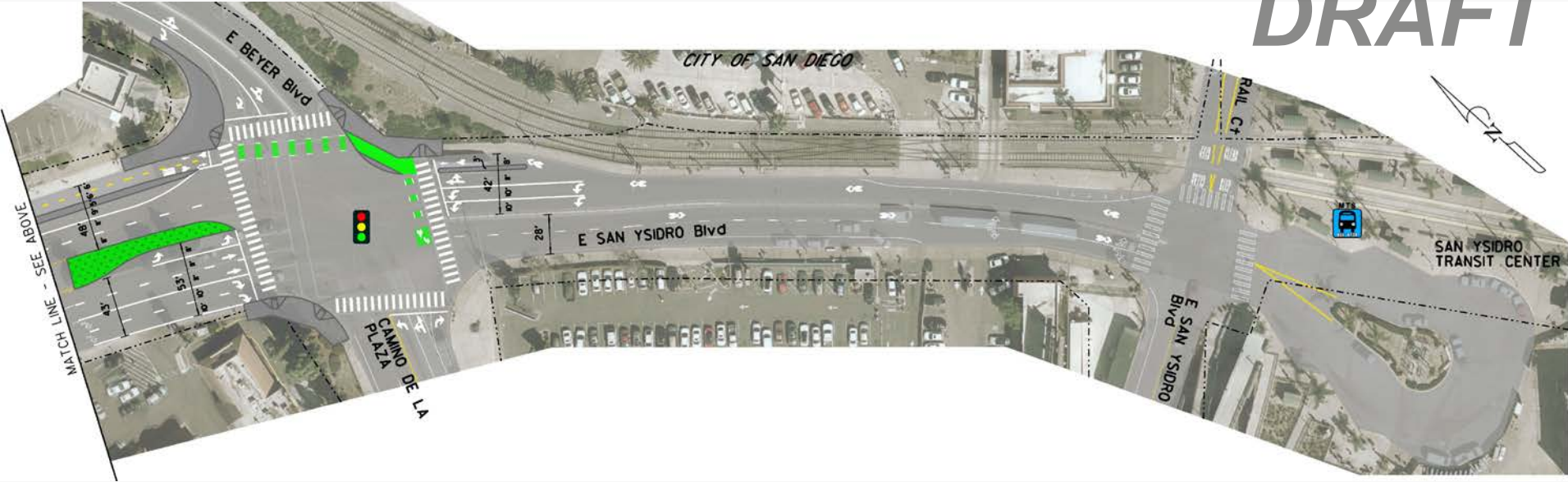



BORDER TO BAYSHORE BIKEWAY SAN YSIDRO

East San Ysidro Boulevard (Segment 4 of 4)

No parking impacts to this segment

DRAFT



No parking impacts to this segment

No Center Turn Lane impacts to this segment



NEXT STEPS

- Continued Community Outreach
 - Imperial Beach (venue and date TBD)
 - Partnering with other events/meetings as opportunities arise
- Open House / Public Hearing
 - Late October 2018 (tentative)
 - Location TBD



TENTATIVE PROJECT TIMELINE





Alison Moss
Project Manager
San Diego Association of Governments
(619) 595-5354 / alison.moss@sandag.org

KeepSanDiegoMoving.com/BordertoBayshore